

Introduction

This Test Interface is a hand held test clip, designed to probe simultaneously the leads of an assembled IC. Terminated with three 25 way male "D" type connectors, the interface makes temporary electrical contact with the leads of the device, in a two step action:

- the interface is positioned over the device to be tested and by pressing gently on the handle, the interface is lined up with the body of the device and the leads;
- by pushing the handle further, the high-performance microprobes will reach the leads of the device and make electrical contact.

Features

- can be easily modified for a 70 pin device by adding the six probes supplied. Excluding the six probes, the interface is wired for a 70 pin device
- achieves the best combination of reliability, repeatability, serviceability and user-friendliness;
- high contact pressure at probe tip, for repeatable and reliable contact;
- high reliability and long life interchangeable microprobes;
- sweeping action gold plated contacts, for reliable contact and low ohmic resistance of interconnections;
- high current rating (for single channel, in ambient air with 70°F [20°C]) : 1.5A
- impact, solvent and temperature resistant plastics, with low friction;
- wide range of operating temperatures (commercial): [0°C to +70°C]
- clear markings on the body, indicating Pin 1 of IC being tested, to prevent probing the wrong way round;
- packaged in a hard wearing, high resistance to damage Polypropylene case with foam insets, the Test Interface can withstand high impact in transit.
- case can be used for safe storage when the Test Interface is not in use, and subsequent transport.
- very flexible cable (military quality harnessing) with low friction, high performance TFE TEFLON insulated wires (MIL-W-16878E Type E, UL1213);

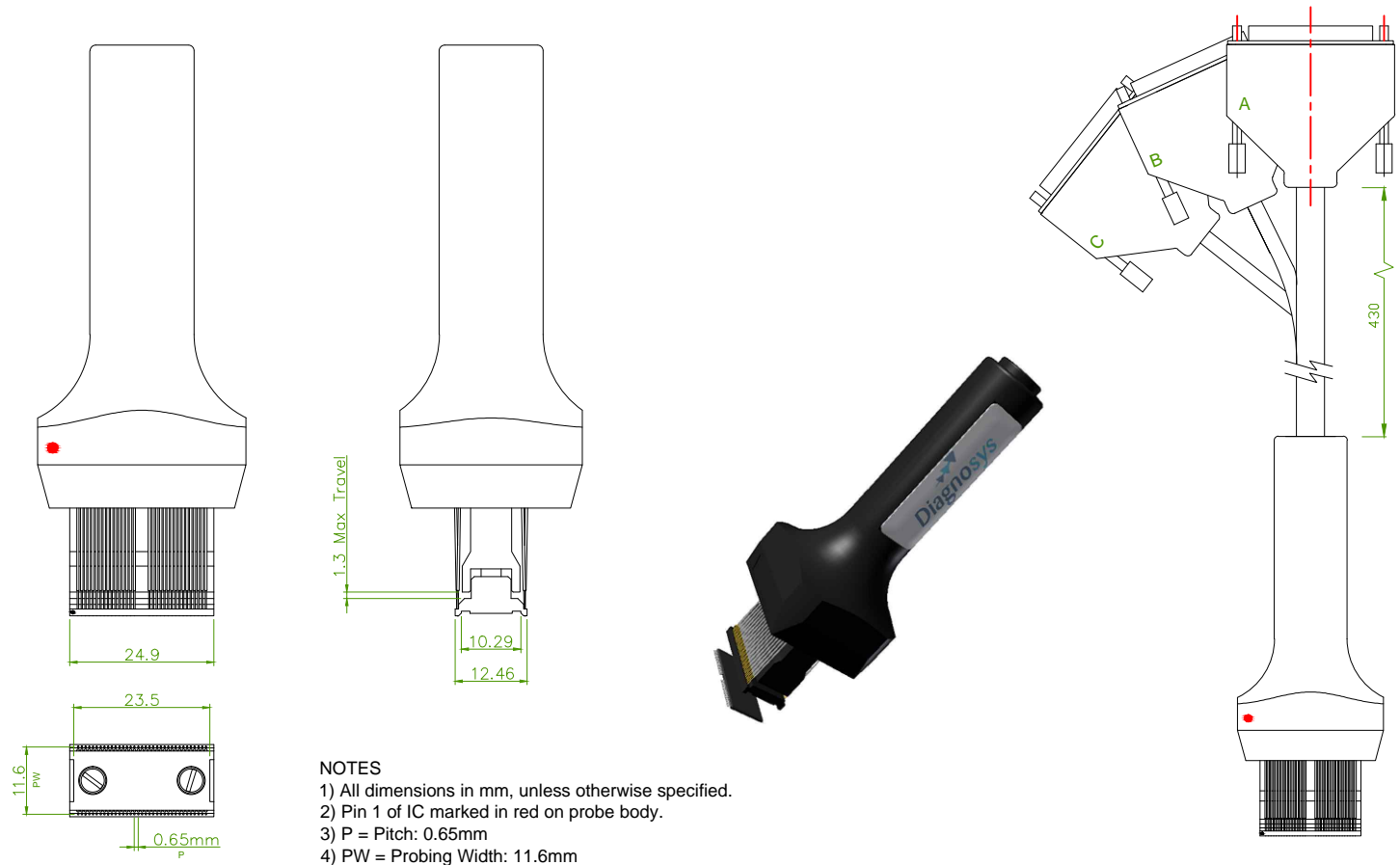

Characteristics

- It will accommodate 70/64 Pin TSOP(II), 0.65mm pitch, LxWxH: 23.5x10x1.2mm;
- Maximum number of interconnections (channels): 70
- Current rating, with all contacts loaded (maximum continuous current, non inductive): 0.5A /channel;
- Contact resistance (average): 80 mΩ /channel;
- Insulation resistance: 5MΩ Min.
- Volume resistivity of plastic parts: 10^{15} Ω-cm @ 50%RH.
- Fatigue life of probes: Min. 1,000,000 cycles at normal working distance;
- Working distance (normal stroke): 1.3mm;
- Microprobe force at point of contact (normal stroke): 0.3N

[illegible]

Viewed from mating plane,
unless otherwise specified

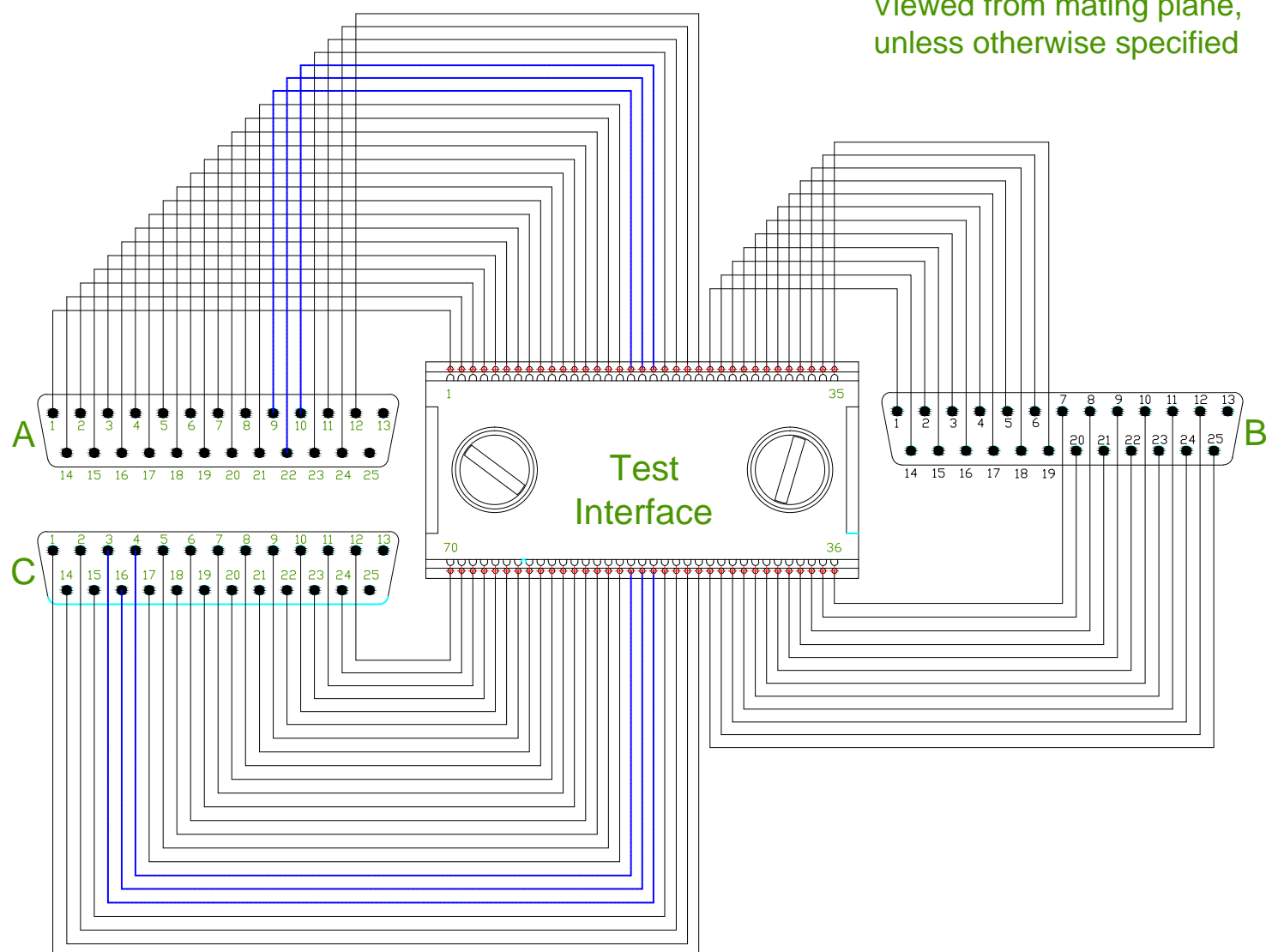

- Interface wired but no probes
- Interface wired and probes attached

© 2014
The copyright in this work is vested in Diagnosys Test Systems Limited. The document is issued in confidence solely for the purpose for which it is supplied. Reproduction in whole or in part or for use for tendering or manufacturing purposes is prohibited except under an agreement with or with the written consent of Diagnosys Test Systems Limited and then only on the condition that this notice is included in any such reproduction. Diagnosys Test Systems Limited has a policy of continuous improvement and reserves the right to change technical specifications at any time without prior notice. Diagnosys Test Systems Limited does not accept liability for errors or misprints in this document.
Diagnosys Test Systems Limited can provide a full range of test clips to meet individual requirements. Any common device packaging styles can be accommodated, or custom designed clips manufactured, for device pitches of 0.4mm and above